

AREA TECNICA

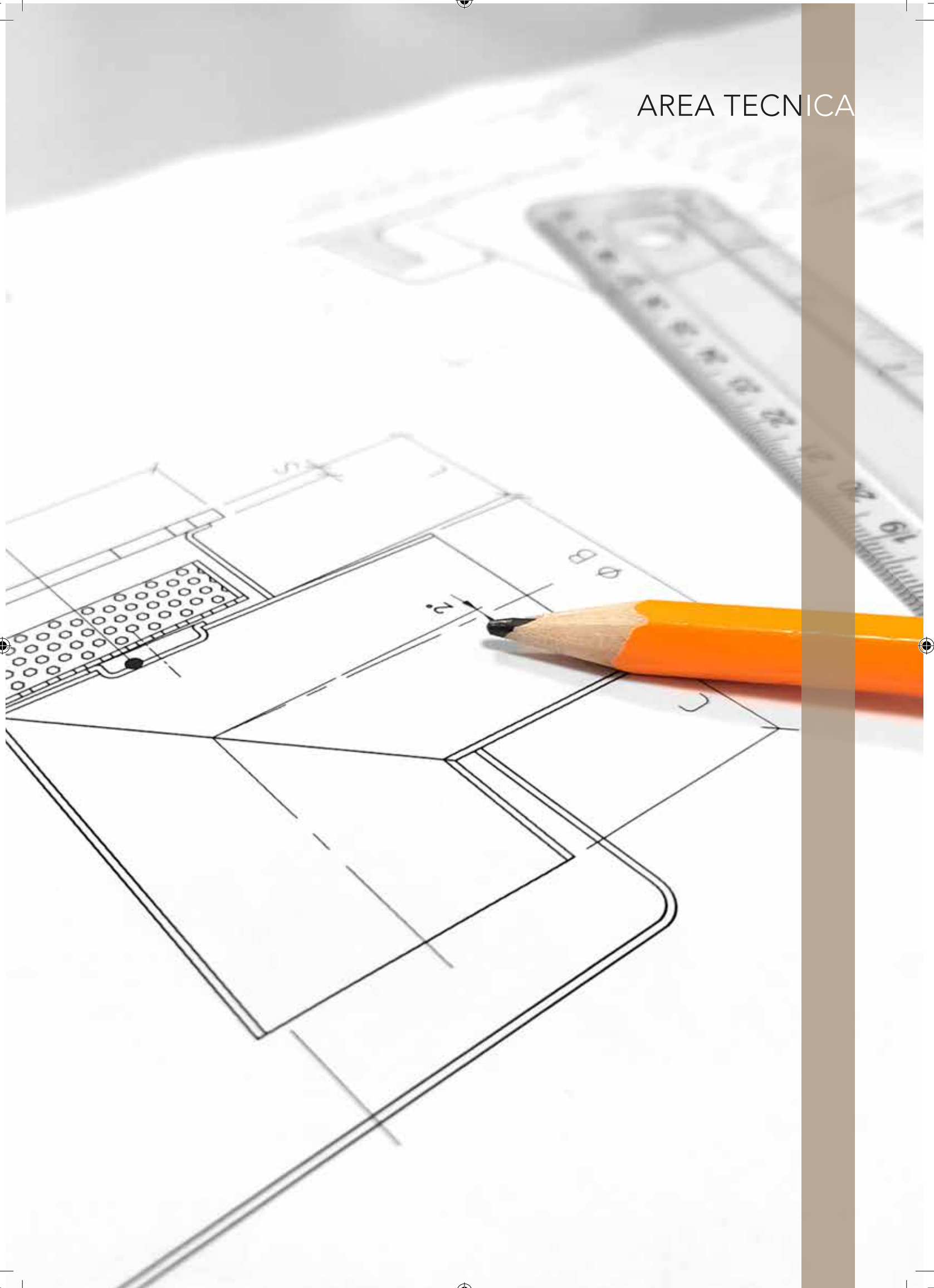

# Luisetto Industry System

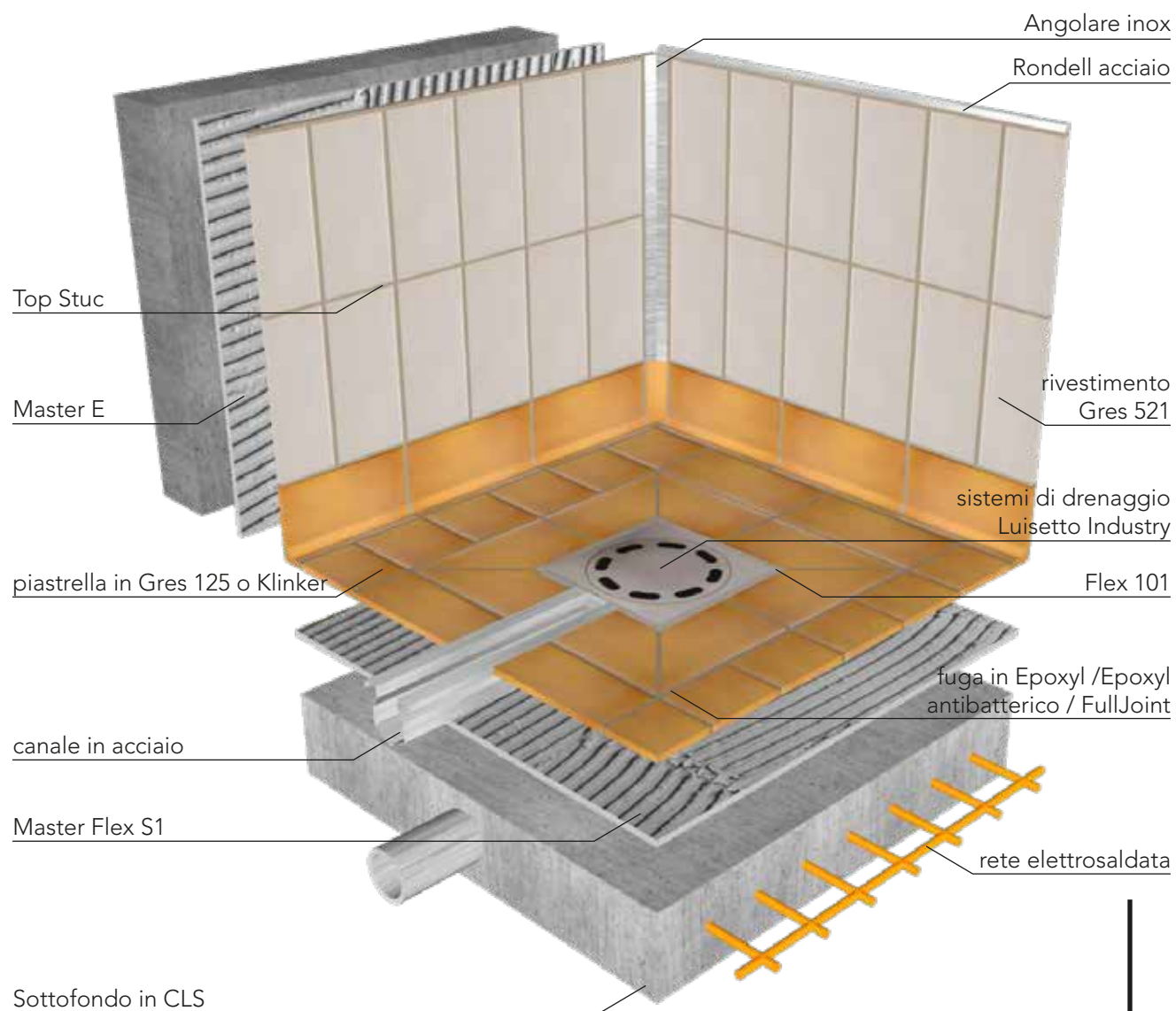

## SOTTOFONDO IN CLS SU ALTRO AGGLOMERATO

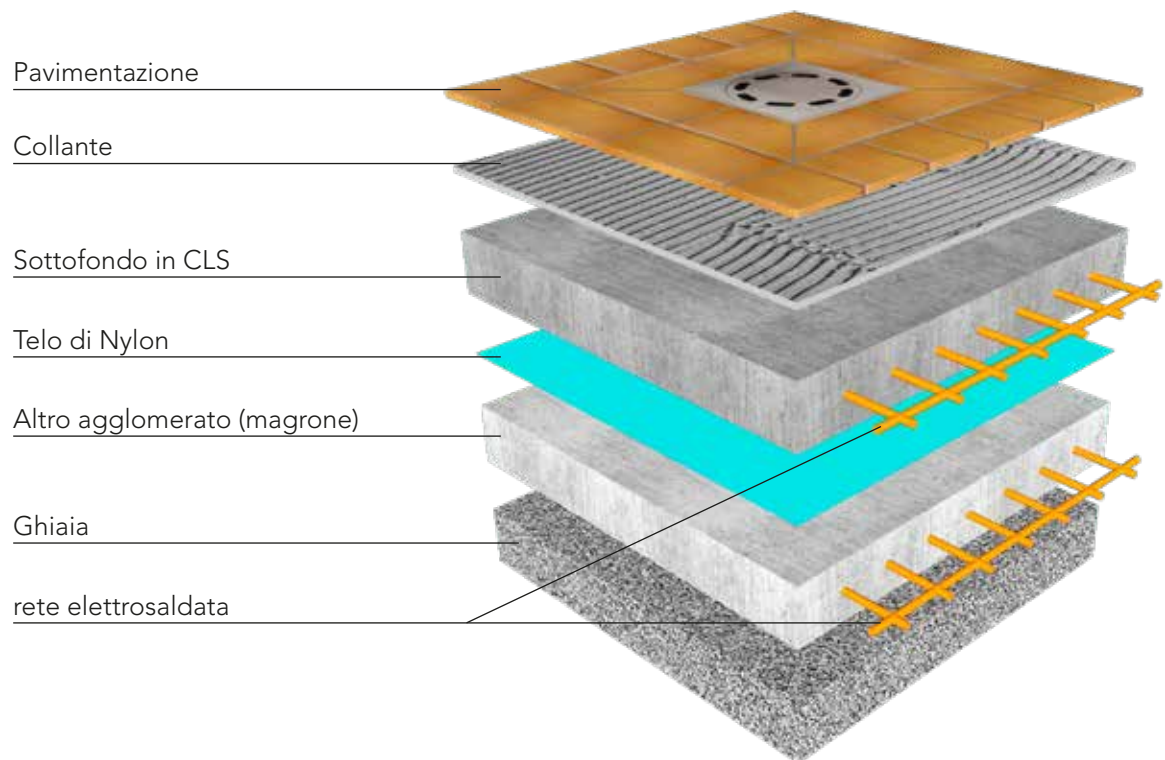

## SOTTOFONDO IN CLS SU GHIAIA SOLUZIONE UNICO GETTO

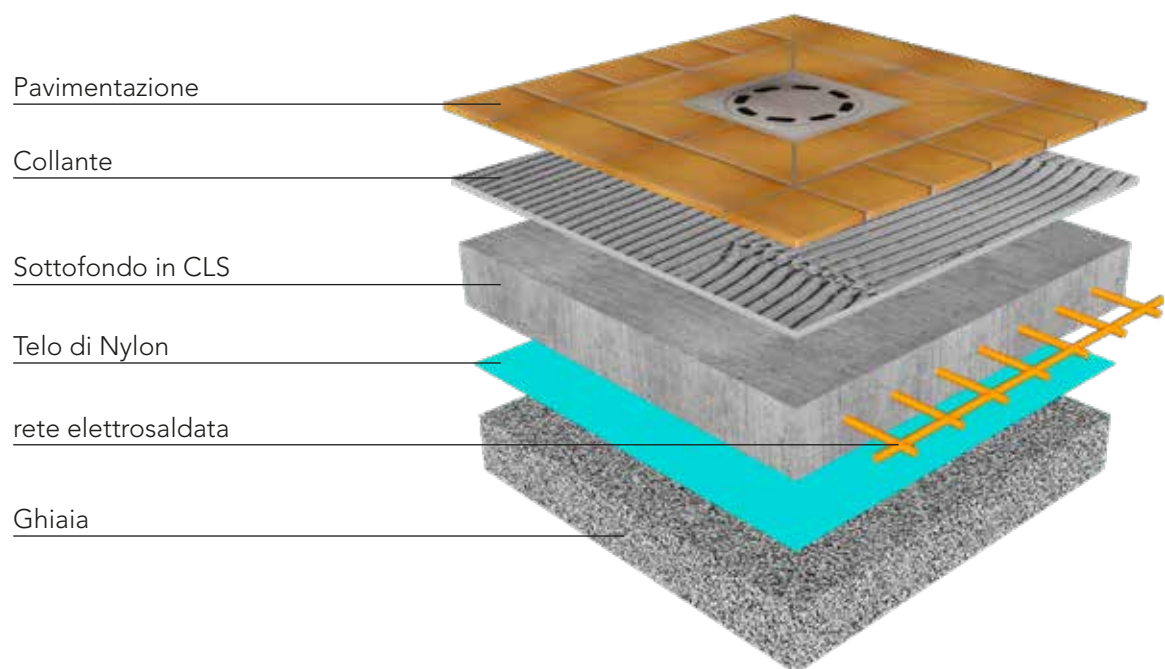

## SOTTOFONDO IN SABBIA E CEMENTO SU ALTRO AGGLOMERATO

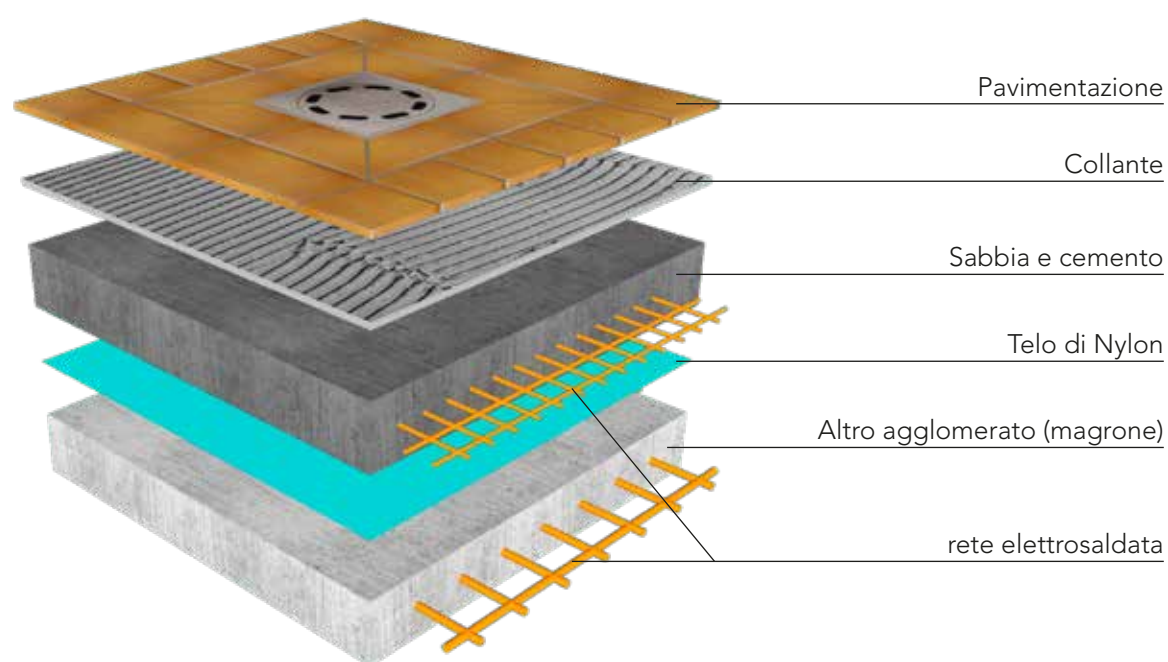

## SOTTOFONDO IN SABBIA E CEMENTO CON GUAINA IMPERMEABILIZZANTE

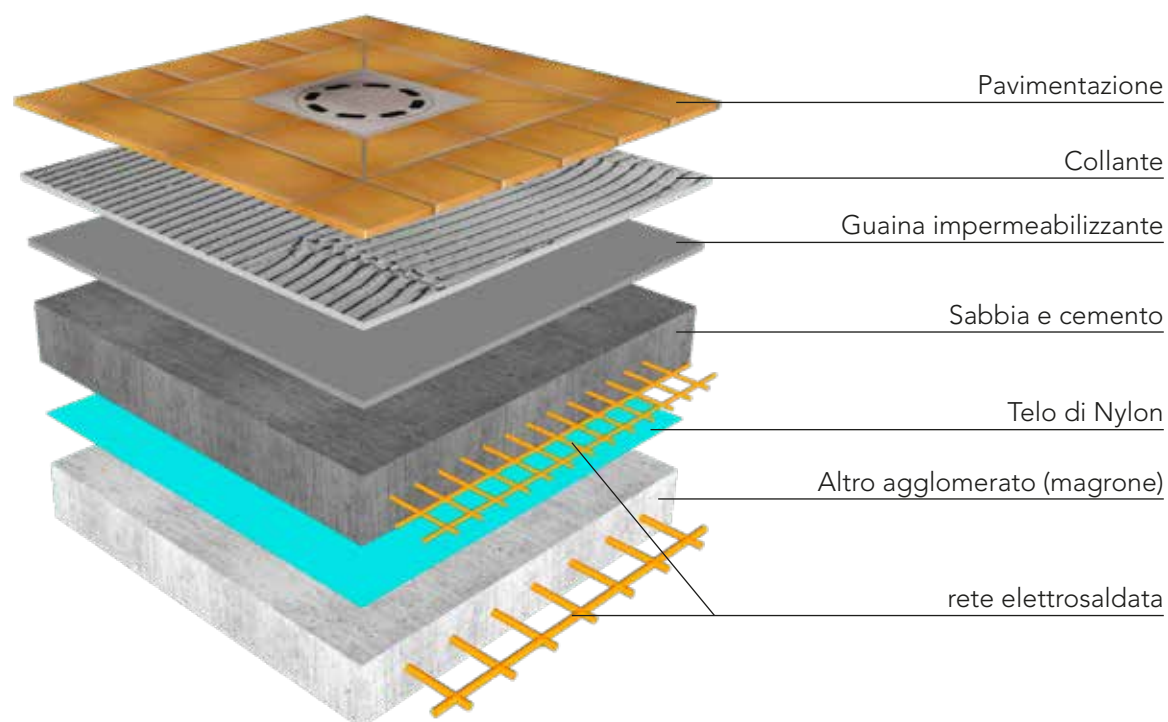



## PARETE IN RIVESTIMENTO GRES 521 CON SGUSCIA SMALTATA

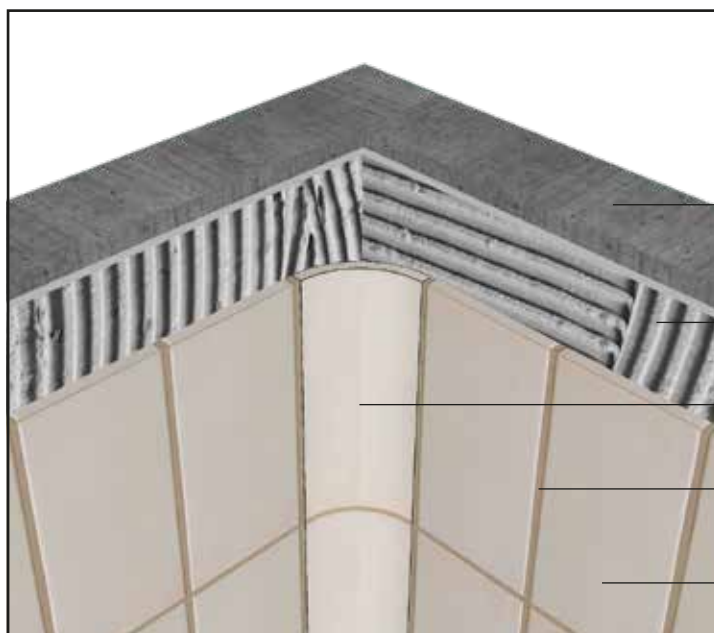

Muratura

Master E

**Sguscia smaltata**

Top Stuc

Rivestimento in Gres 521

## RONDELL ACCIAIO SU LUISETTO INDUSTRY SYSTEM

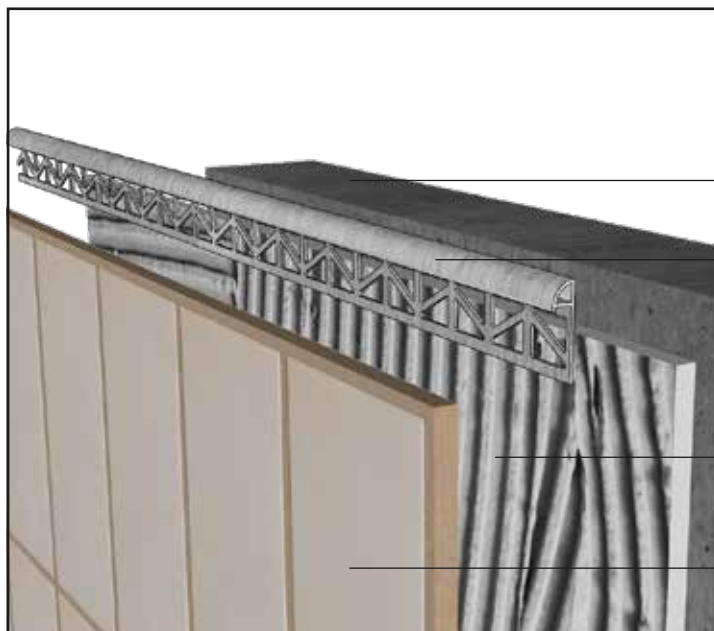

Muratura

**Rondell acciaio**

Collante

Rivestimento in Gres 521

## PARETE IN RIVESTIMENTO GRES 521 CON SGUSCIA IN ACCIAIO INOX

Muratura

Master E

Sguscia Inox

Top Stuc

Rivestimento in Gres 521

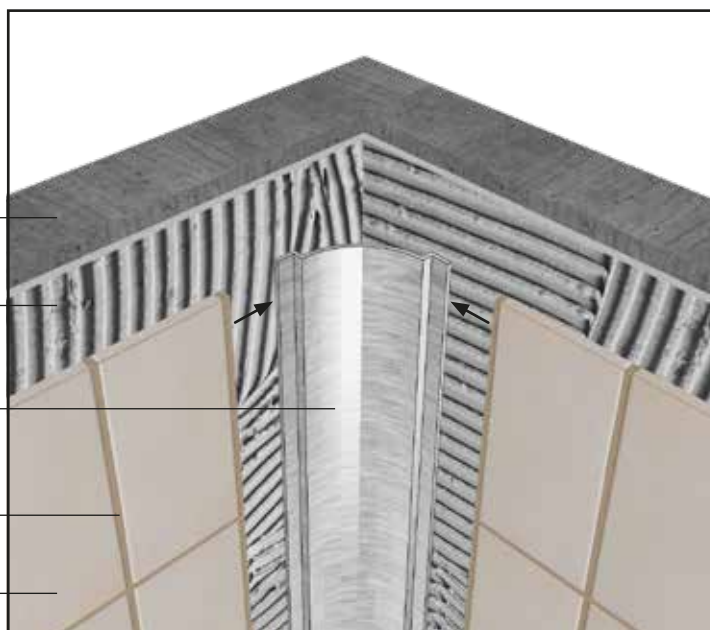

## PARETE IN RIVESTIMENTO GRES 521 CON PARASPIGOLO IN ACCIAIO INOX

Muratura

Master E

Paraspigolo raccordato Inox

Top Stuc

Rivestimento in Gres 521

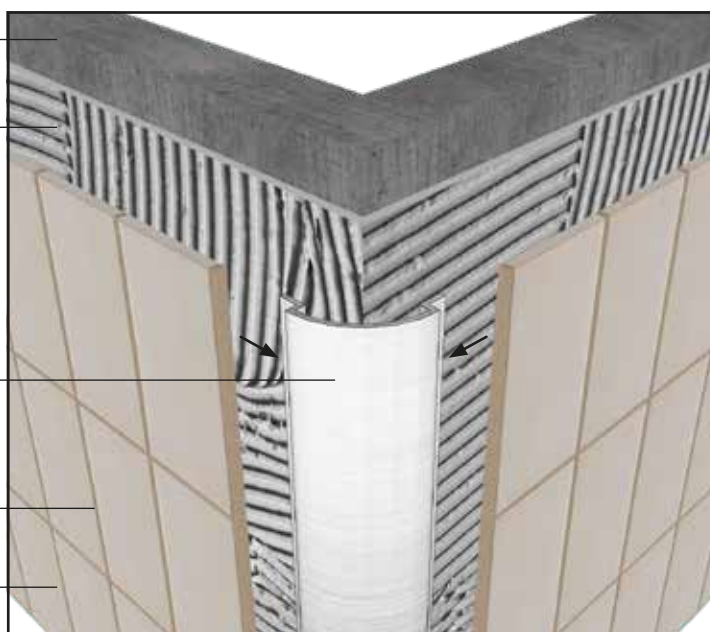

## TERMINALE SOGLIA SU LUISETTO INDUSTRY SYSTEM

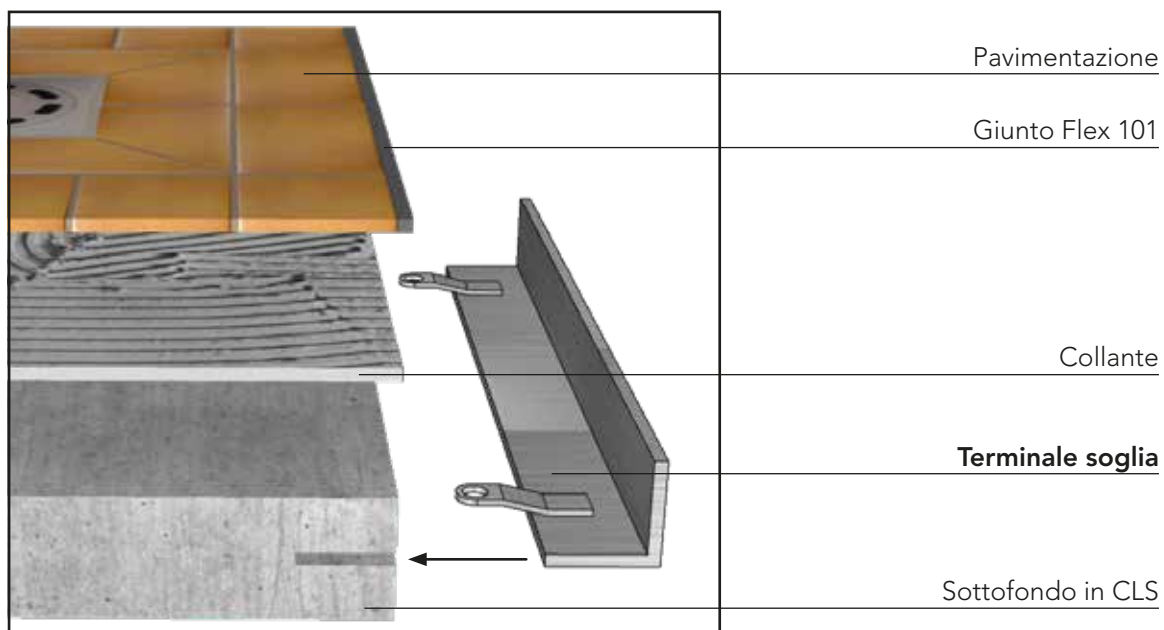

## BATTISCOPA Z.T.R. E BATTISCOPA Z.B.C. SU LUISETTO INDUSTRY SYSTEM

battiscopa Z.T.R.

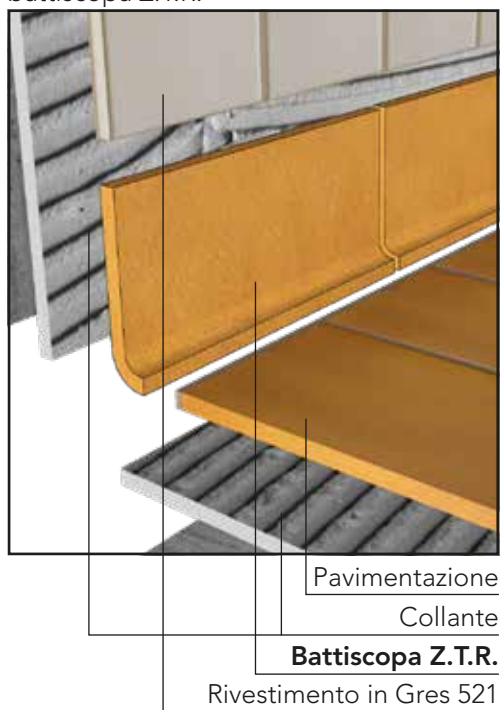

battiscopa Z.B.C.

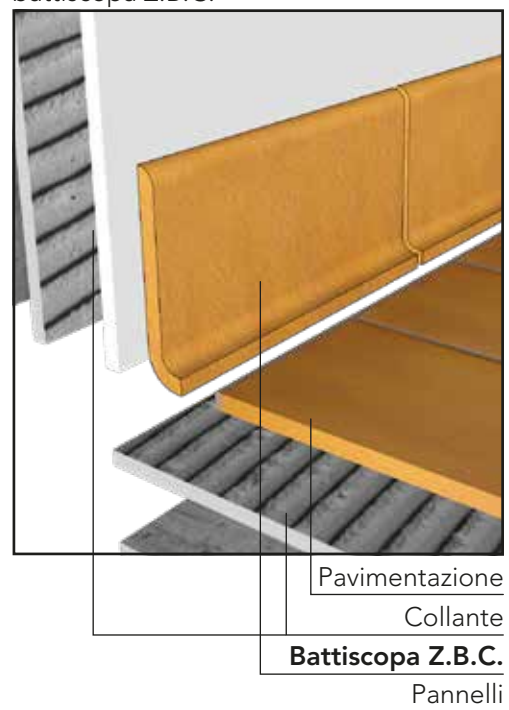

## CORRETTO ISOLAMENTO TERMICO (per celle a 0° o - 0°)

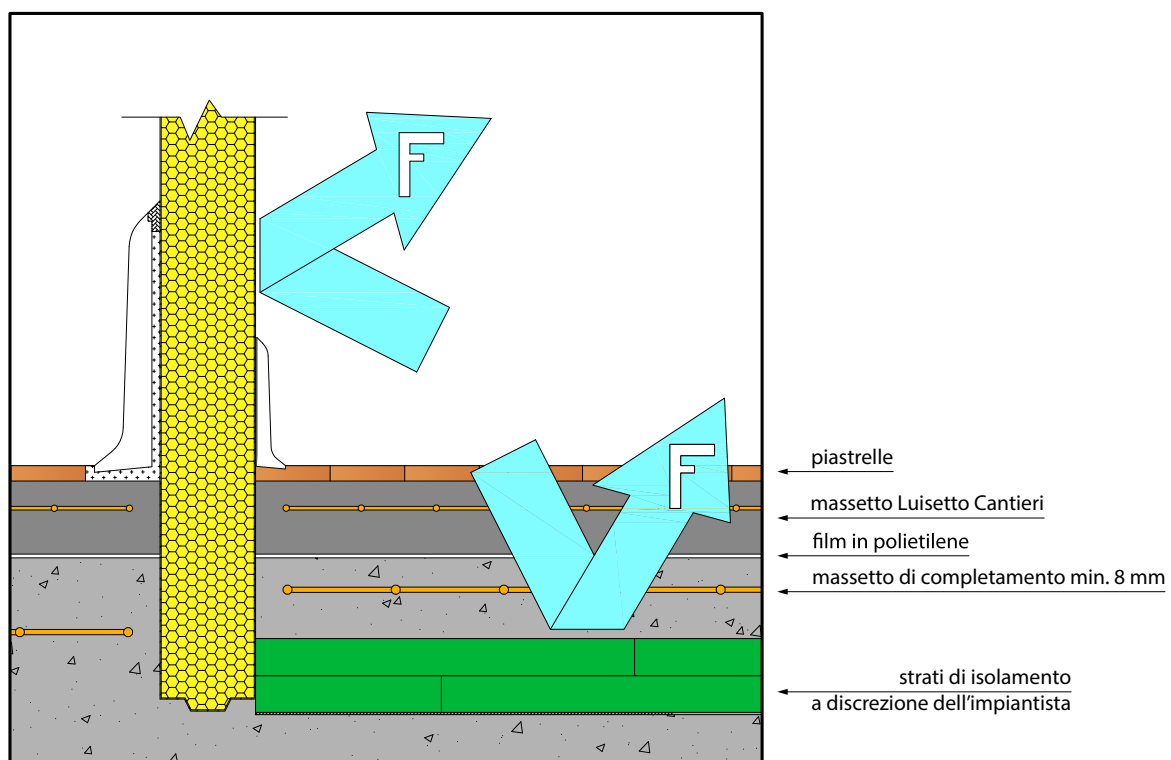
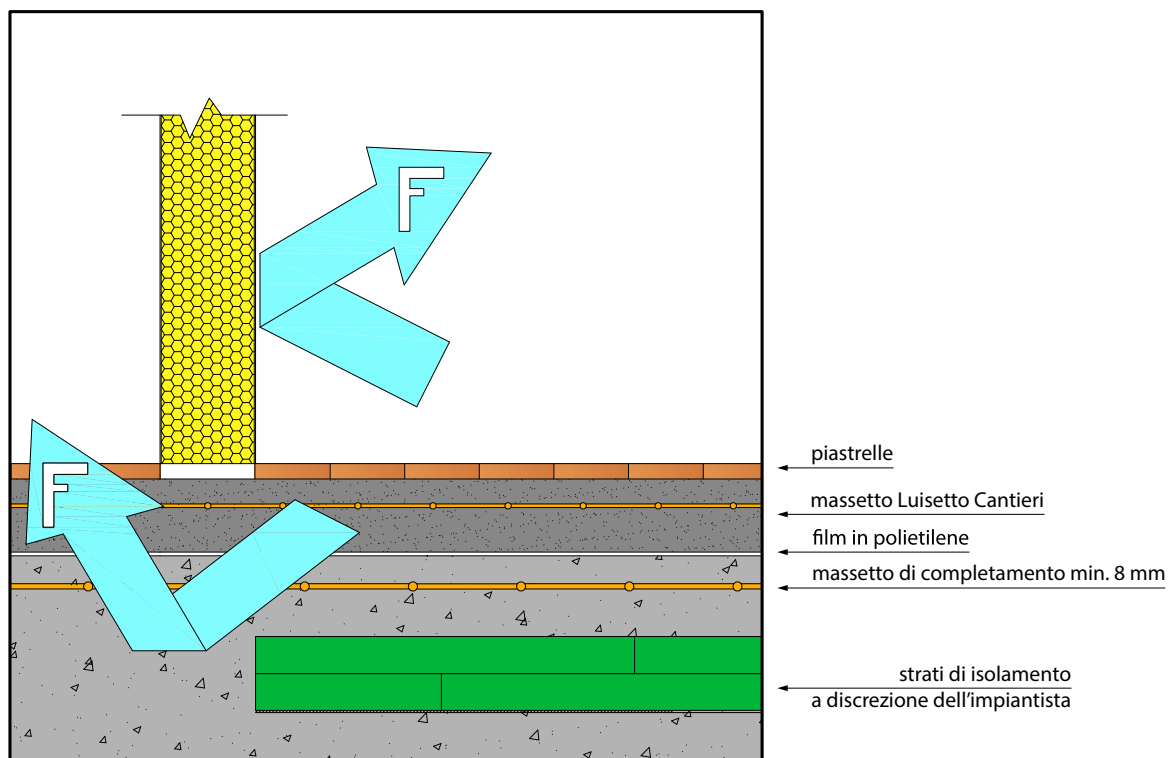



## SEZIONE PAVIMENTO

(unico getto in CLS su sottofondo in ghiaia)

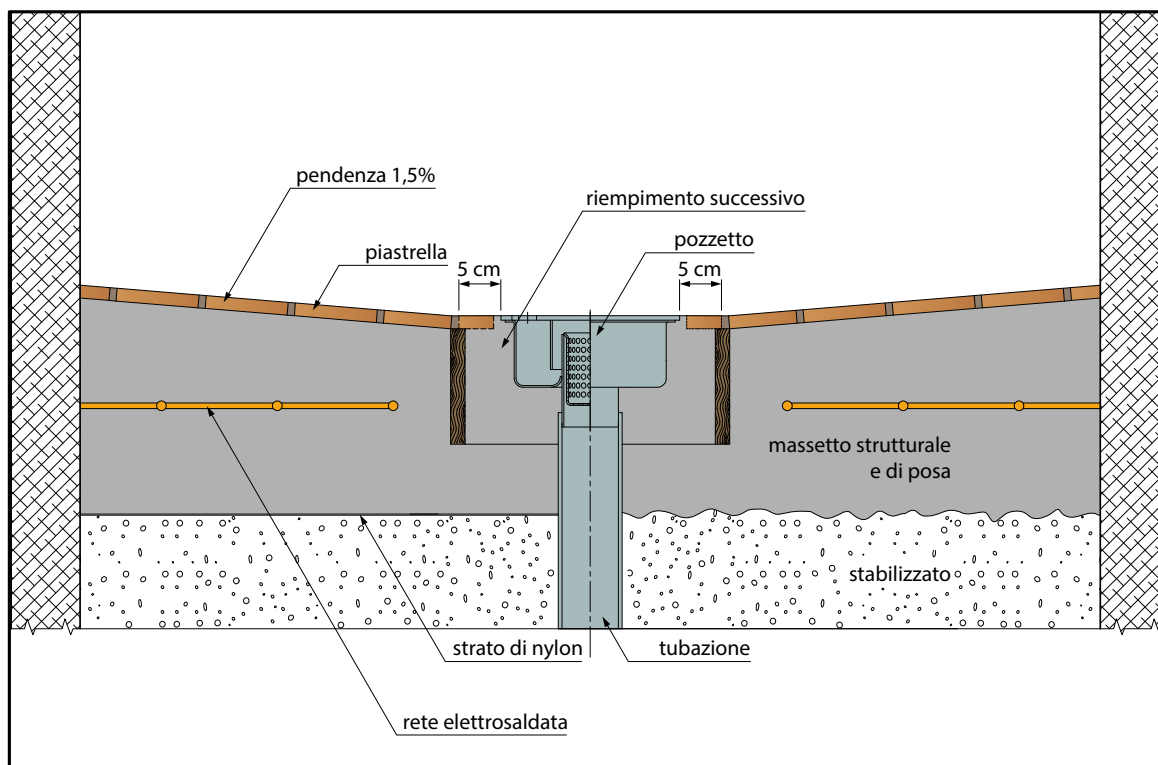

## SEZIONE PAVIMENTO

(getto in CLS o sabbia e cemento su sottofondo in altro agglomerato)

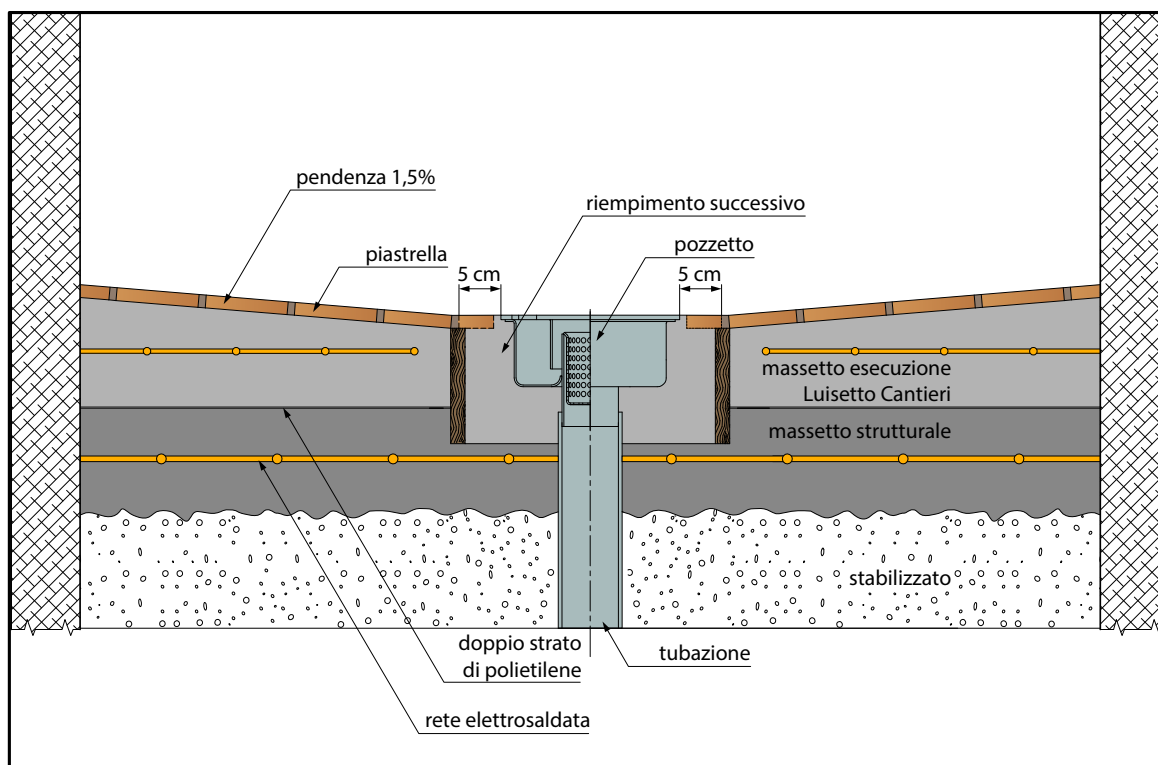

## SEZIONE PAVIMENTO

(getto in CLS o sabbia e cemento su sottofondo in altro agglomerato, già in pendenza)

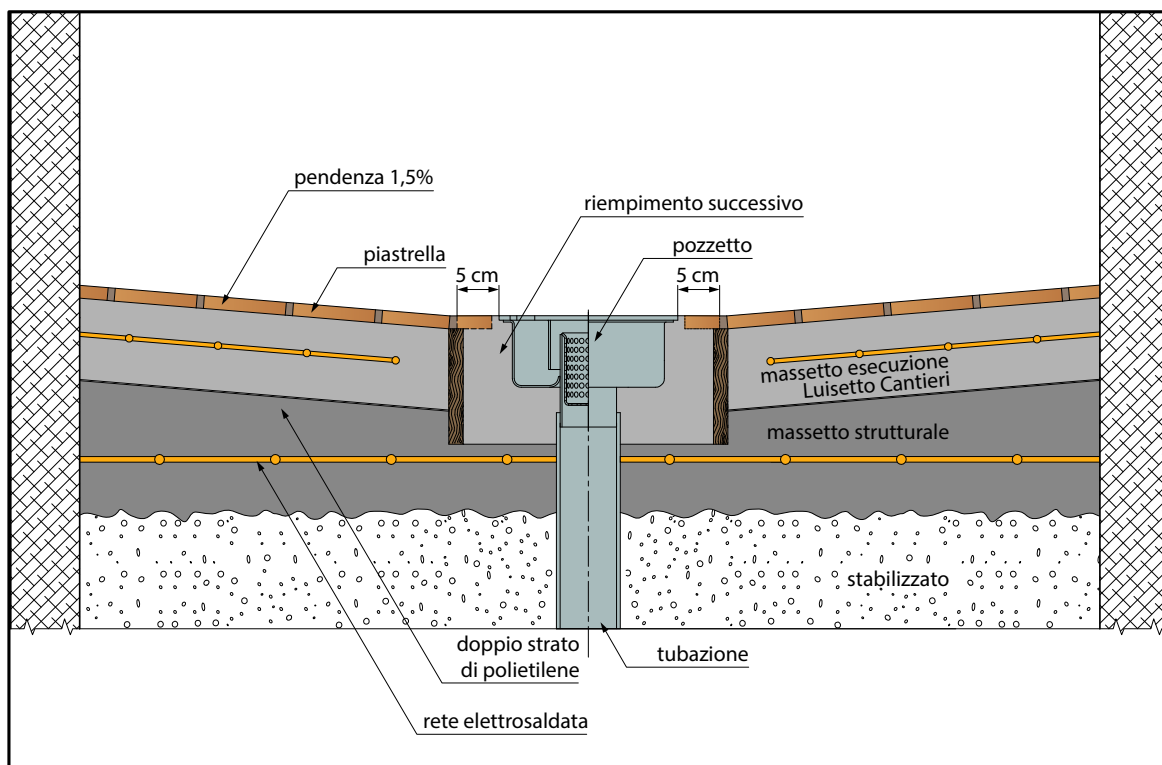

## SEZIONE PAVIMENTO

(posizione canalina)

